

GASSHIELD® C-SEAL SURFACE MOUNT FILTERS

1.5 nm FILTRATION

mott
MISSION CRITICAL PRECISION

TEESING

WE MAKE YOUR TECHNOLOGY WORK

GSMM-75 SERIES - STAINLESS STEEL FIBER METAL MEDIA

DESCRIPTION

Mott High Purity Surface Mount Filters provide 9-log filtration of particles down to 0.0015 μm resulting in particle-free gas and are engineered specifically for Integrated Gas System (IGS) assemblies. These filters offer flow ratings up to 50 slpm and are compatible with most popular compact modular substrate systems. Flow passages are equivalent to 1/4" tubing.



APPLICATIONS

For use with C-Seal 1.125" surface mount gas delivery systems. Compatible with all inert gases and most specialty gases for gas system interfaces specified on process tools, gas cabinets, and valve manifold box installations.

OPERATING CONDITIONS

- » Maximum Operating Pressure: 500 psig (34.5 barg)
- » Maximum Operating Temperature for Inert Gas: 460°C
- » Maximum Differential Pressure: 100 psid (6.9 bar)

MATERIALS

- » Hardware: 316L SS VAR
- » Filter Medium: 316L SS Fiber
- » Wetted Hardware Surface Finish: 5 Ra

| FEATURES | BENEFITS |
|-------------------------|---|
| All-Metal Capabilities | Withstands high temperatures and pressures |
| All-Welded Construction | No mechanical seals |
| Standard IGS Interface | Consumes less space than in-line designs. Easy retrofit |
| Design Flexibility | Wide range of materials, configurations and flow rates |
| Modular IGS Design | Ease of installation, reduced part variations and inventories |

SPECIFICATIONS

| | |
|--|--|
| Particle Removal Size: | $\geq 0.0015 \mu\text{m}$ |
| Filter Efficiency (Log Reduction Value): | ≥ 9 LRV (99.9999999% reduction in particles). Confirmed at the most penetrating particle size of 0.08 μm per SEMI F38-0699 test method |
| Helium Leak Rating: | 1×10^{-9} atm cc/sec |
| Moisture Contribution: | <10 ppb after 1 hour at low-flow ambient purge per SEMI F27 test method |
| Total Hydrocarbons: | Below detectable limits per SEMASPEC 90120396B test method |
| Particle Shedding: | Zero particle contribution above background (<1 particle/ft ³) per SEMI F43-0308 test method |

Warranty:

Mott Corporation ("Mott") warrants its GasShield filter will meet the specified retention and media integrity standards for a period of five years from the date of purchase, providing the filter is properly installed and used in accordance with the specified flow, pressure, temperature, and chemical compatibility as published by Mott. Mott will replace or grant a purchase price refund for any GasShield filter which proves defective under the terms of this limited warranty. No other remedies apply. Mott disclaims all other warranties, either expressed or implied, including any warranty of merchantability or fitness for a particular purpose. Mott shall have no liability for consequential incidental, special or punitive damages, lost profits or savings, or damages from lost production or damage to other materials.

FLOW DATA

Mott GSMM-75-010-14 Flow Rate vs. Differential Pressure

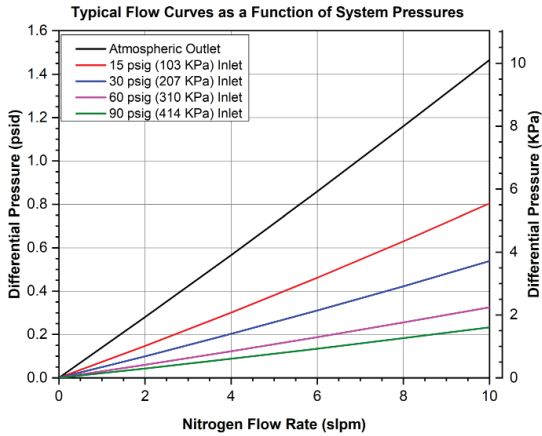

Mott GSMM-75-030-14 Flow Rate vs. Differential Pressure

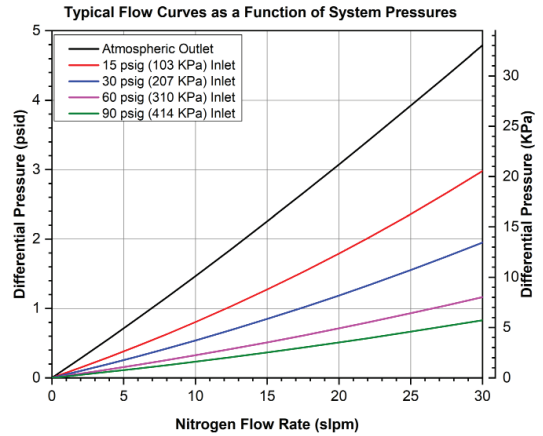

Mott GSMM-75-050-14 Flow Rate vs. Differential Pressure

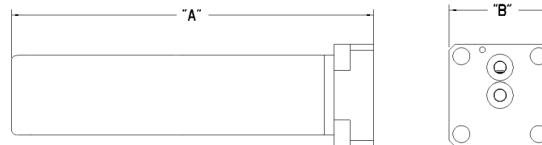
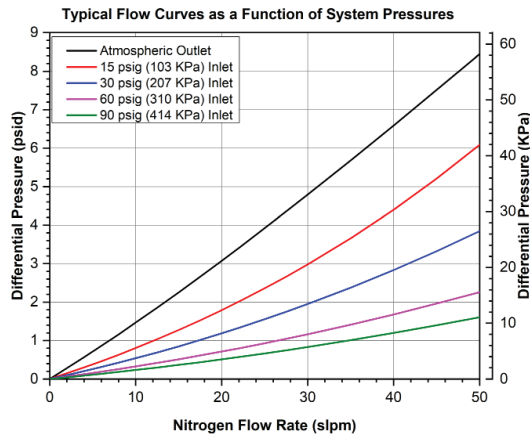

ORDERING INFORMATION

| Part Description | Part Number | Fitting Type | Filter Design | Flow Rating (SLPM) | A Inches / mm |
|------------------|-------------|--------------|---------------|--------------------|---------------|
| GSMM-75-010-14 | 6813175 | C-Seal | 1.125" | 10 | 2.6 / 66.0 |
| GSMM-75-030-14 | 6813176 | C-Seal | 1.125" | 30 | 2.6 / 66.0 |
| GSMM-75-050-14 | 6813177 | C-Seal | 1.125" | 50 | 2.6 / 66.0 |

*Custom designs and fittings available. Contact a Mott representative for more information.